

DIP TYPE (基板端) SERIES

unit:mm

D10
D121

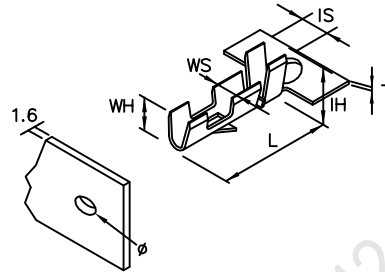

P.C.B LAYOUT

C/W: CRIMPING WIDTH

P/NO.	WIRE RANGE	T	L	WS	WH	IS	IH	P.C.B(φ)	C/W	P.C.B(T)	Material	Finish	Qty/reel
D10	AWG#24-28	0.15	5.8	1.5	1.3	2.4	2.4	φ1.0	0.8	1.2-1.6	BRASS	Tin-plated	15,000
D121	AWG#24-28	0.2	6.8	1.2	1.4	2.3	1.9	φ1.2	1.0				10,000

D262
D1831
D161

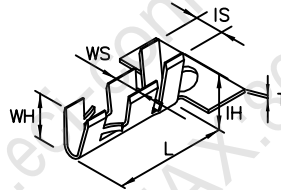

P/NO.	WIRE RANGE	T	L	WS	WH	IS	IH	P.C.B(φ)	C/W	P.C.B(T)	Material	Finish	Qty/reel
D262 D262-P	AWG#24-28	0.2	6.1	2.7	3.0	5.0	5.0	φ2.6	2.2	1.6	BRASS PHOSPHOR	Tin-plated	3,500
D1831 D262-P	AWG#24-28	0.2	6.0	2.3	2.3	3.8	3.4	φ1.8	1.55	1.2-1.6			7,000
D161 D161-P	AWG#24-28	0.2	6.0	2.3	2.1	4.8	3.4	φ1.6	1.4	1.6	BRASS PHOSPHOR		13,000

D182(低)
D185(高)

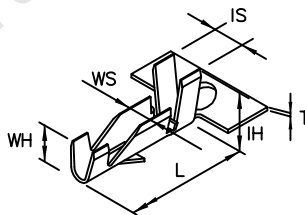

P/NO.	WIRE RANGE	T	L	WS	WH	IS	IH	P.C.B(φ)	C/W	P.C.B(T)	Material	Finish	Qty/reel
D182(?)	AWG#18-22	0.2	7.0	2.0	1.9	4.4	4.2	φ1.8	1.55	1.2-1.6	BRASS	Tin-plated	5,000
D185(?)	AWG#18-22	0.2	7.0	2.9	2.6	5.7	4.6	φ1.8	1.55				3,500

D1831A
D161A
D262A

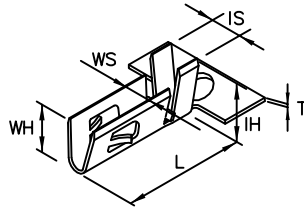

P/NO.	WIRE RANGE	T	L	WS	WH	IS	IH	P.C.B(φ)	C/W	P.C.B(T)	Material	Finish	Qty/reel
D1831A D1831A-P	AWG#18-24	0.2	6.0	2.3	2.3	3.8	3.4	φ1.8	1.55	1.6	BRASS PHOSPHOR	Tin-plated	7,000
D161A	AWG#22-26	0.2	6.0	2.3	2.1	4.8	3.4	φ1.6	1.4	1.6			BRASS
D262A D262A-P	AWG#18-2C	0.2	6.1	2.7	3.0	5.0	5.0	φ2.6	2.2	1.6	BRASS PHOSPHOR		3,500

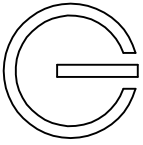

DIP TYPE (基板端) SERIES

D122

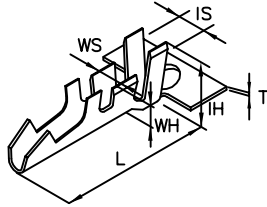

P/NO.	WIRE RANGE	T	L	WS	WH	IS	IH	P.C.B(φ)	C/W	P.C.B(T)	Material	Finish	Qty/reel
D122	AWG#18-22		5.75	2.1	2.3	4.3	4.0	1.8	1.55	1.2-1.6	BRASS	TIN plated	7,000

1133

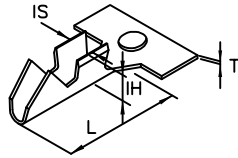

P/NO.	WIRE RANGE	T	L	IS	IH	P.C.B(φ)	C/W	P.C.B(T)	Material	Finish	Qty/reel
1133	AWG#18-22	0.2	4.2	1.5	0.97	1.8	1.55	1.2-1.6	BRASS	TIN plated	20,000

E019

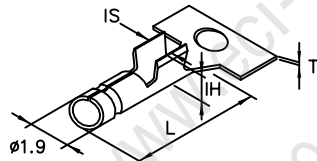

P/NO.	WIRE RANGE	T	L	IS	IH	P.C.B(φ)	C/W	P.C.B(T)	Material	Finish	Qty/reel
E019	AWG#18-22	0.15	6.2	2.0	1.6	1.8	1.55	1.2-1.6	BRASS	TIN plated	10,000

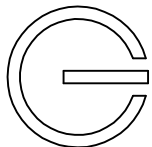

DIP TYPE (基板端) SERIES

unit:mm

D184

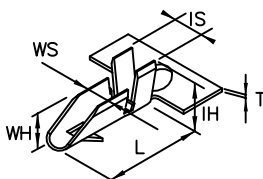

P/NO.	WIRE RANGE	T	L	WS	WH	IS	IH	P.C.B(∅)	C/W	P.C.B(T)	Material	Finish	Qty/reel
D184	AWG#18-22		5.75	2.1	2.3	4.3	4.0	1.8	1.55	1.2-1.6	BRASS	Tin-plated	5,000

D32

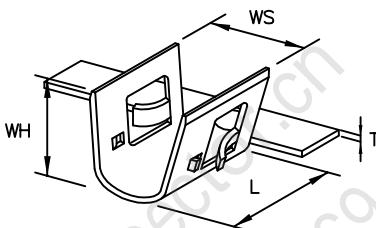

P/NO.	WIRE RANGE	T	L	WS	WH	IS	IH	P.C.B(∅)	C/W	P.C.B(T)	Material	Finish	Qty/reel
D32-P	AWG#18-22	0.3	5.7	5.6	4.4	4.3	4.0	3.2	1.55	1.6	PHOSPHOR	Tin-plated	4,500

D321

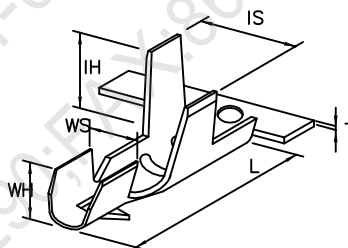

P/NO.	WIRE RANGE	T	L	WS	WH	IS	IH	P.C.B(∅)	C/W	P.C.B(T)	Material	Finish	Qty/reel
D321-P	AWG#18 2C-6C	0.25	14.3	5.4	5.0	10.0	8.4	3.2	2.5	1.2-1.6	PHOSPHOR	Tin-plated	2,000

D180

D181

D186

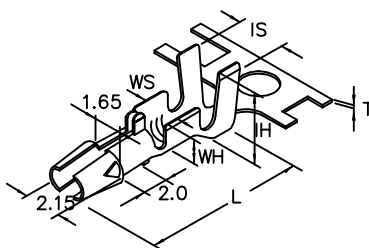

P/NO.	WIRE RANGE	T	L	WS	WH	IS	IH	P.C.B(∅)	C/W	P.C.B(T)	Material	Finish	Qty/reel
D180	AWG#20-26	0.25	10.4	2.0	1.9	3.4	3.3	∅1.8	1.55	1.6	BRASS	Tin-plated	7,000
D181	AWG#18-22	0.25	10.4	2.2	2.3	3.6	3.8	∅1.8	1.55				7,000
D186	AWG#16-20	0.25	10.4	2.7	3.0	5.0	5.3	∅1.8	1.55				3,500

8811

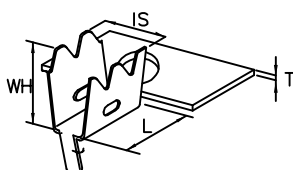

P/NO.	WIRE RANGE	T	L	WS	WH	IS	IH	P.C.B(∅)	C/W	P.C.B(T)	Material	Finish	Qty/reel
8811	AWG#18 2C-6C		14.3	5.4	5.0	10.0	8.4	3.2	2.5	1.6	BRASS	Tin-plated	2,500