

2520 SERIES

2.5mm PITCH BOARD IN CONNECTOR

● Specifications

Current rating: 3A AC,DC

Voltage rating: 250V AC,DC

Temperature range: -25° C to+85° C
(including temperature rise)

Contact resistance: Initial value/10m Ω Max.

After environmental testing/20m Ω Max.

Insulation resistance: 1000M Ω MIN.

Withstanding voltage: 1000V AC/minute

Applicable wire: AWG#22-28

● Standards



E115256



LR84767

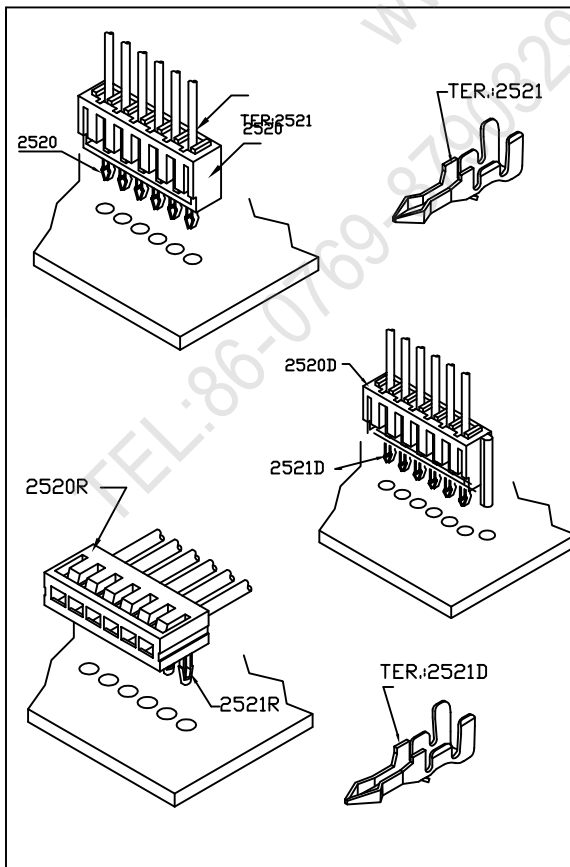

Assembly layout

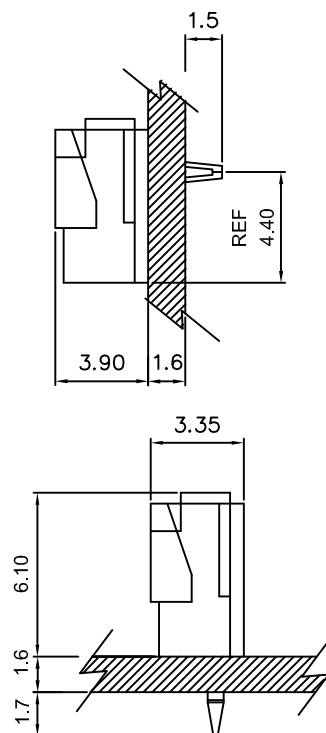



2520

2.50mm CRIMP HOUSING

Features:

MAT'L: NYLON 66 UL94V-0

MATES WITH: 2521 2521D SERIES TERMINAL

unit:mm

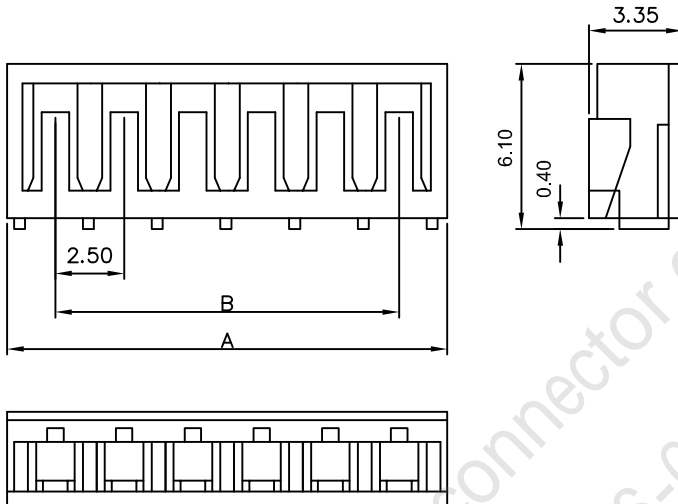

PART NO.	A	B
2520-02	6.5	2.5
2520-03	9.0	5.0
2520-04	11.5	7.5
2520-05	14.0	10.0
2520-06	16.5	12.5
2520-07	19.0	15.0
2520-08	21.5	17.5
2520-09	24.0	20.0
2520-10	26.5	22.5
2520-11	29.0	25.0
2520-12	31.5	27.5
2520-13	34.0	30.0
2520-14	36.5	32.5
2520-15	39.0	35.0
2520-16	41.5	37.5

2521R 2521SR 2.50mm PITCH CRIMP TERMINAL

Features:

THICKNESS: 0.2mm

MAT'L: BRASS TIN PLATED

USE WITH 1.6mm OR 1.2mm THICK P.C BOARD

MATES WITH: 2520R SERIES HOUSING

TERMINAL SOLDER DIRECTLY TO P.C BOARD

unit:mm

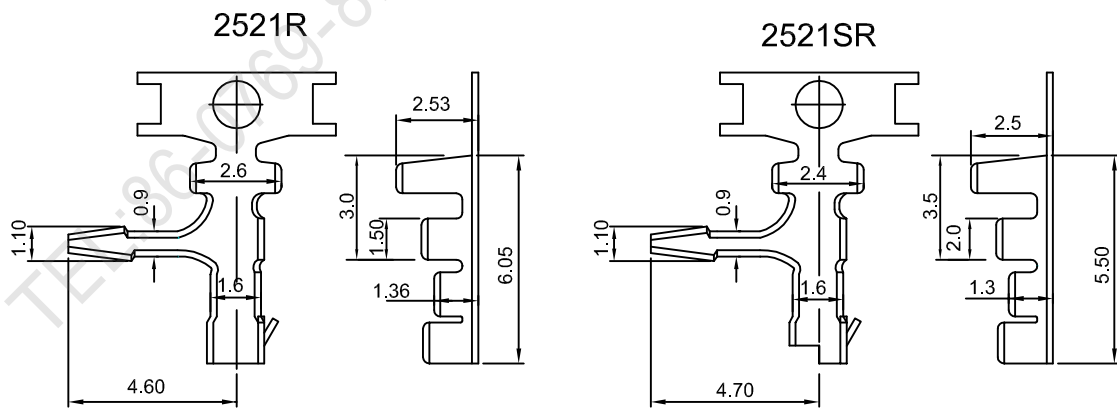
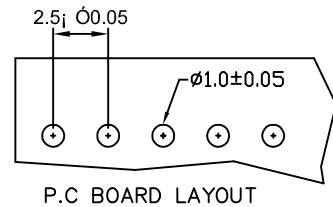

Part No	Wire Range	Insulation O.D.	Material	Finish	Qty/reel
2521R	#22-#28	∅1.9 mm max	BRASS	Tin-plated	10,000
2521SR	#22-#28	∅1.9 mm max	BRASS	Tin-plated	10,000

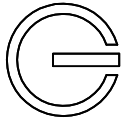

2521D 2.50mm PITCH CRIMP TERMINAL

Features:

THICKNESS: 0.2mm
 MAT'L: BRASS TIN PLATED
 USE WITH 1.6mm OR 1.2mm THICKNESS P.C.B
 MATES WITH: 2520D SERIES HOUSING
 TERMINAL SOLDER DIRECTLY TO P.C BOARD

unit:mm

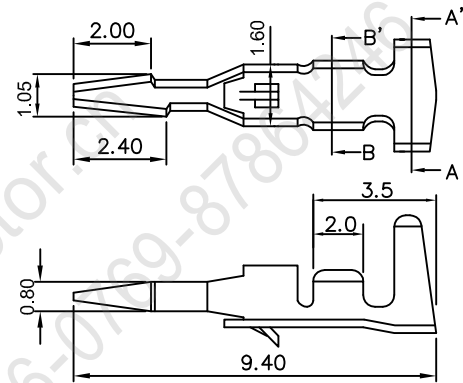
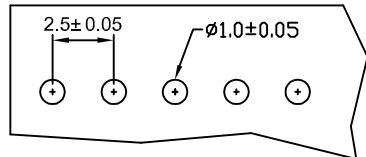
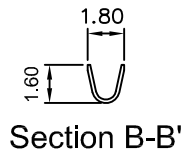
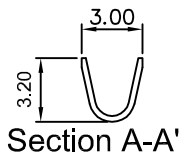

Part No	Wire Range	Insulation O.D.	Material	Finish	Qty/reel
2521D	#22-28	ø1.9mm max	BRASS	Tin-plated	10,000

2521 2.50mm PITCH CRIMP TERMINAL

Features:

THICKNESS: 0.2mm
 MAT'L: BRASS TIN PLATED
 USE WITH 1.6mm OR 1.2mm THICKNESS P.C.B
 MATES WITH: 2520 SERIES HOUSING
 TERMINAL SOLDER DIRECTLY TO P.C BOARD

unit:mm

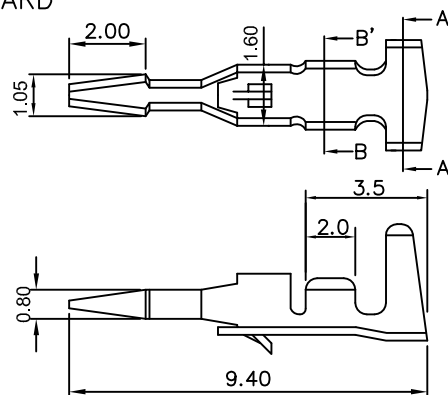
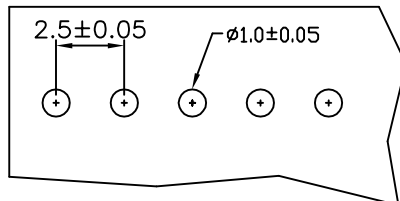
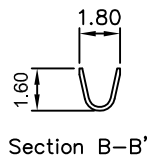
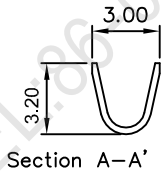

Part No	Wire Range	Insulation O.D.	Material	Finish	Qty/reel
2521	#22-28	ø1.9mm max	BRASS	Tin-plated	10,000



2520R 2.50mm CRIMP HOUSING

Features:

MAT'L: NYLON 66 UL94V-2

MATES WITH: 2521R SERIES TERMINAL

unit:mm

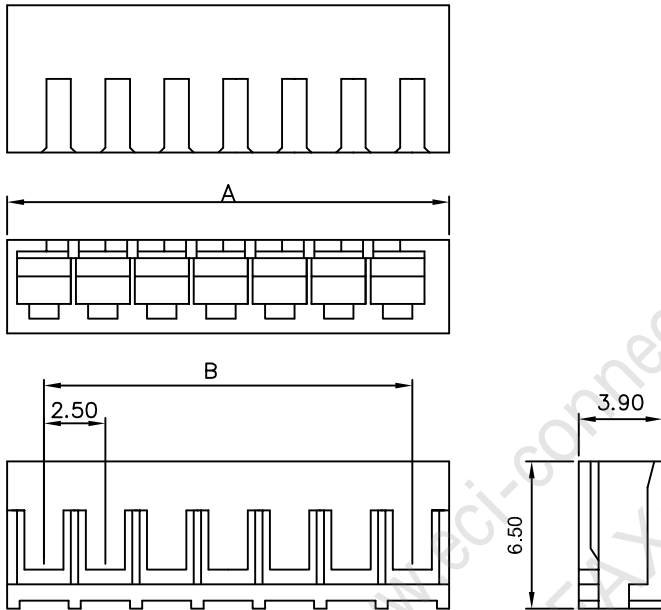

PART NO.	A	B
2520R- 02	6.5	2.5
2520R- 03	9.0	5.0
2520R- 04	11.5	7.5
2520R- 05	14.0	10.0
2520R- 06	16.5	12.5
2520R- 07	19.0	15.0
2520R- 08	21.5	17.5
2520R- 09	24.0	20.0
2520R- 10	26.5	22.5
2520R- 11	29.0	25.0
2520R- 12	31.5	27.5
2520R- 13	34.0	30.0
2520R- 14	36.5	32.5
2520R- 15	39.0	35.0
2520R- 16	41.5	37.5

2520D SERIES 2.50mm PITCH CRIMP TERMINAL HOUSING

Features:

MAT'L: NYLON 66 UL94V-0

MATES WITH: 2521D SERIES TERMINAL

unit:mm

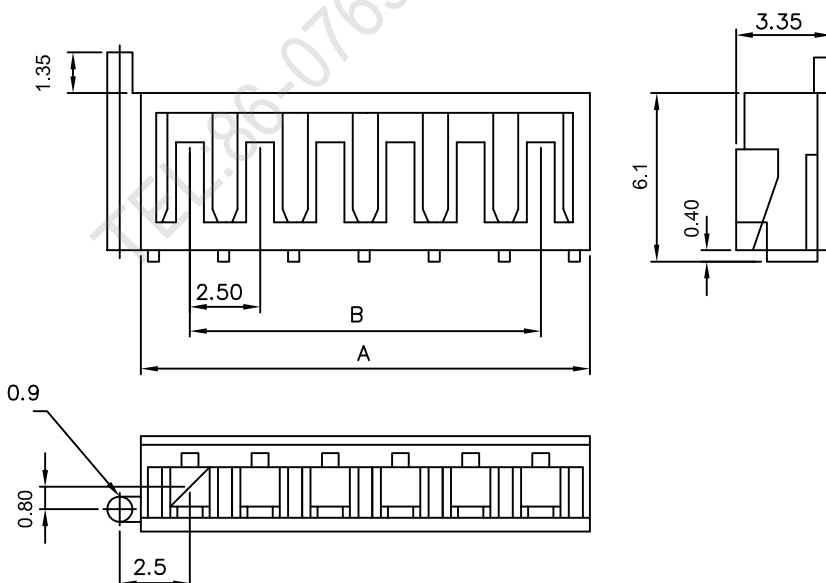

PART NO.	A	B
2520D- 02	6.5	2.5
2520D- 03	9.0	5.0
2520D- 04	11.5	7.5
2520D- 05	14.0	10.0
2520D- 06	16.5	12.5
2520D- 07	19.0	15.0
2520D- 08	21.5	17.5
2520D- 09	24.0	20.0
2520D- 10	26.5	22.5
2520D- 11	29.0	25.0
2520D- 12	31.5	27.5
2520D- 13	34.0	30.0
2520D- 14	36.5	32.5
2520D- 15	39.0	35.0
2520D- 16	41.5	37.5